

# 40 F COTTERS LANE

East Brunswick, New Jersey 08816

Total Building SF:	68,200 SF
Available SF:	34,600 SF
Office SF:	3,042 SF
Year Built:	1980
Clear Height:	21'
Column Span:	40' X 42'
Sprinklers:	wet
Power:	300 AMPS 277/480v
Loading Doors:	6 tailgates 3 rail doors
Parking:	Ample



**Melissa Camarata – Leasing Director**  
[melissac@greekdevelopment.com](mailto:melissac@greekdevelopment.com)

**Beth Magnani – Leasing Associate**  
[bethm@greekdevelopment.com](mailto:bethm@greekdevelopment.com)



For further information please call:

**F. Greek Development**

732.257.7353

33 Cotters Lane | East Brunswick, New Jersey 08816

## Floor Plan:

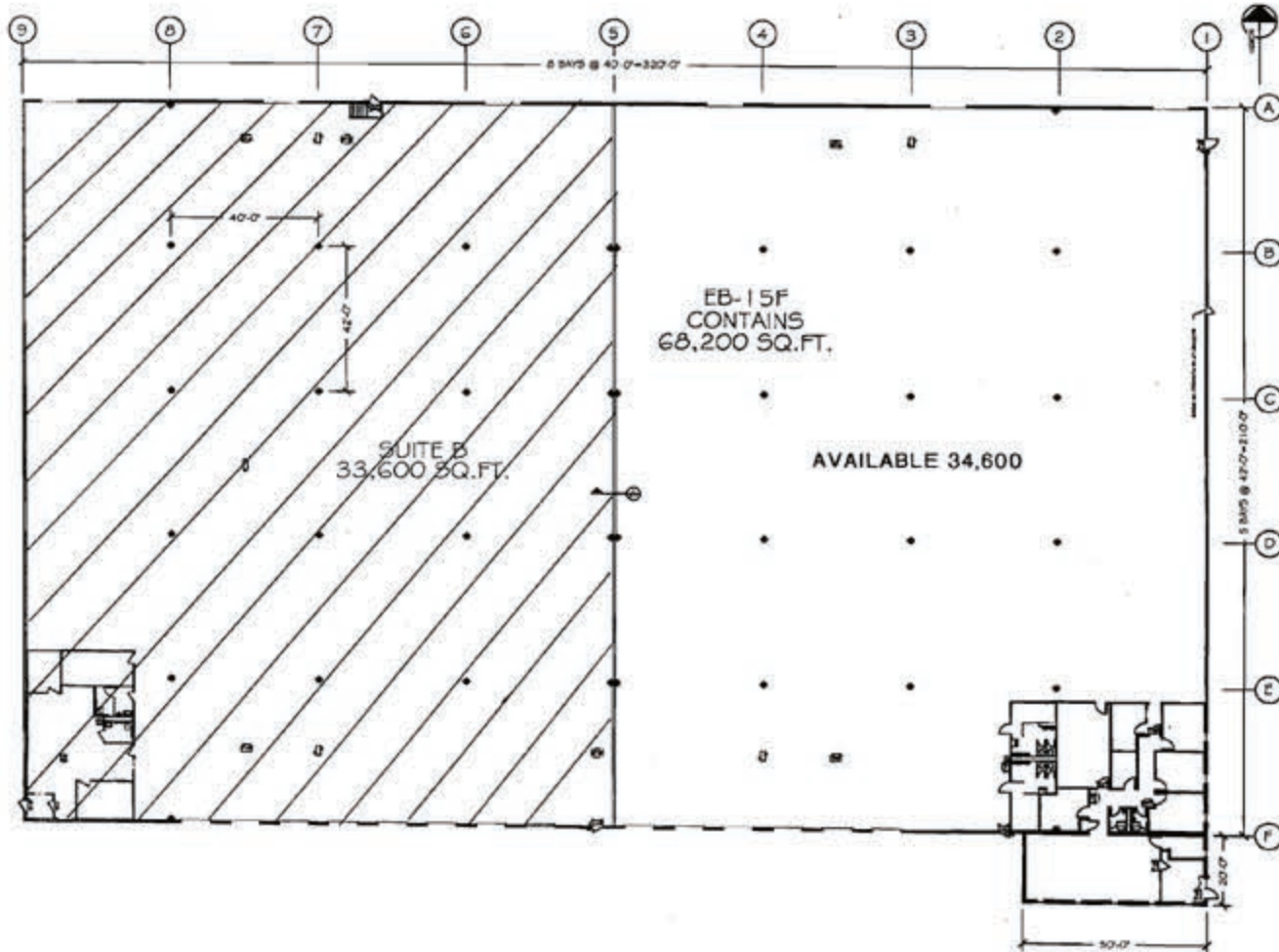

For further information please call:

**F. Greek Development**

732.257.7353

33 Cotters Lane | East Brunswick, New Jersey 08816